

FORM NO 1.

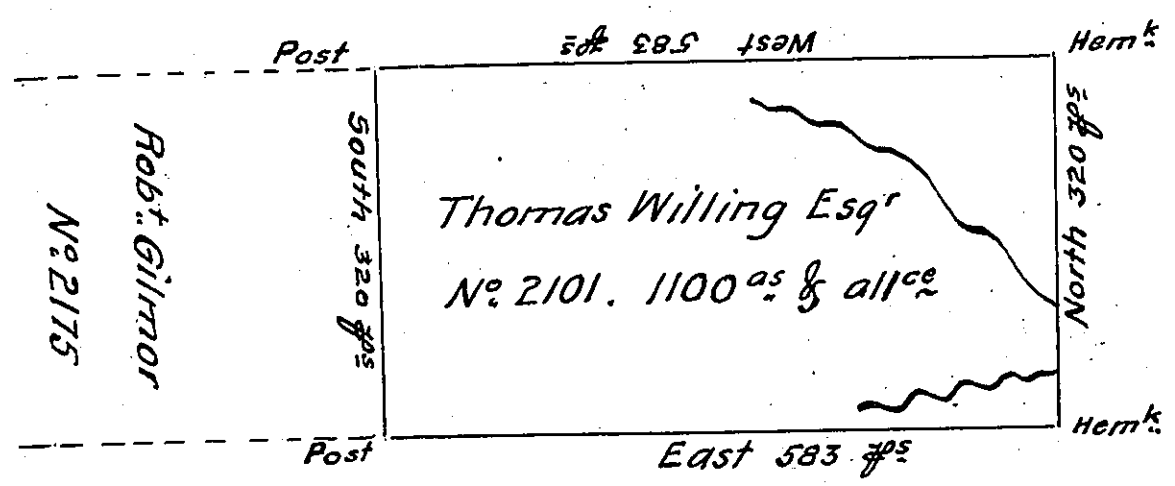

In pursuance of a warrant No. 2101 dated December 12th 1792 Survey^d 3^d July 1793 to Thomas Willing Esq^r the above Described tract of Land Situated on a small Branch of the Sinnamahoning and adjoining Lands of Robt. Gilmor in the Late purchase Northumberland County in District No. 2. Containing Eleven hundred acres and allowance of six $\frac{7}{8}$ Cent.

Daniel Brodhead Esquire Jr. Brodhead D.S.
 Surveyor General.

IN TESTIMONY that the above is a copy of the original remaining on file in the Department of Internal Affairs of Pennsylvania, made conformably to an Act of Assembly approved the 16th day of February, 1833, I have hereunto set my Hand and caused the Seal of said Department to be affixed at Harrisburg, this twenty-second day of August 1907

Henry Howell
 Secretary of Internal Affairs.